

2

1

ZONE	REV.	DESCRIPTION	BY	ECNNUMBER
------	------	-------------	----	-----------

Mounts to current lights  
(no change to design)

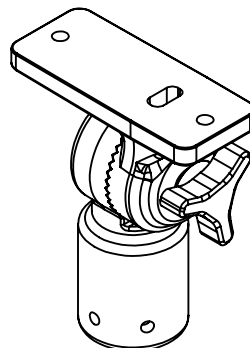
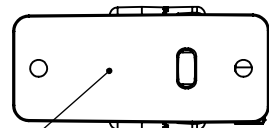

for -TW option  
cable gland  
hole is tapped on  
side of collar

(3) 1/4-28 tapped  
holes for set screws to  
secure to pole

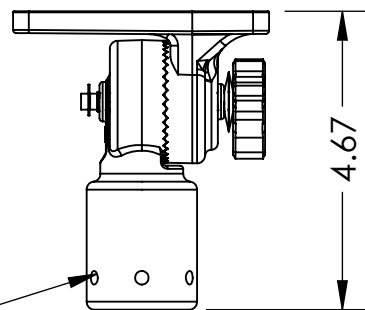

Accepts std 1 1/4" OD pole

E Style Shaft Retaining Ring  
(same on previous design)



Updated Swivel Casting  
with added material  
for addition strength

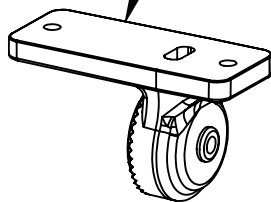

Key Belleville Washers  
(same on previous design)

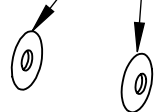

Single-Piece  
Casting for Arm/Pole Mount

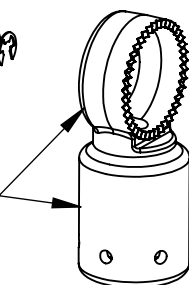

Updated Knob  
Tri-Lobe handle

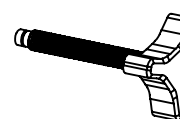

FINISH:		DRAWN BY:	DATE:
MATERIAL:		CHECKED BY:	DATE:
TOLERANCE UNLESS OTHERWISE SPECIFIED 2 PLACE DEC. ±.015 3 PLACE DEC. ±.005 ANGLES ±.1° UNLESS OTHERWISE SPECIFIED DIMENSIONS ARE IN INCHES		MODEL NUMBER	WEIGHT (LBS)
INTERPRET DIMENSIONS AND TOLERANCES PER ASME Y14.5M			0.9
CAD MODEL FILE NAME: Swivel-Pole Adapter		 THIRD ANGLE PROJECTION	
THIS PRINT AND ALL DATA AND OTHER CONTENT CONTAINED HEREIN ARE PROPRIETARY TO, AND THE SOLE AND EXCLUSIVE PROPERTY OF, FIRE RESEARCH CORP. ("FRC"), AND MAY NOT BE DISCLOSED TO OTHERS WITHOUT THE EXPRESS WRITTEN CONSENT OF FRC. THIS PRINT MUST BE RETURNED TO FRC IMMEDIATELY UPON REQUEST. © 2020 FIRE RESEARCH CORP. ALL RIGHTS RESERVED.			

<b>FIRE RESEARCH CORP</b>			
26 SOUTHERN BLVD., NESCONSET, NY 11767, USA			
DESCRIPTION			
XXXXXXXXXX			
SIZE	DRAWING NUMBER	REV.	
A		1	
CAD SCALE	1:4	SHEET	1 OF 1

2

1